

Model RBA4098-911

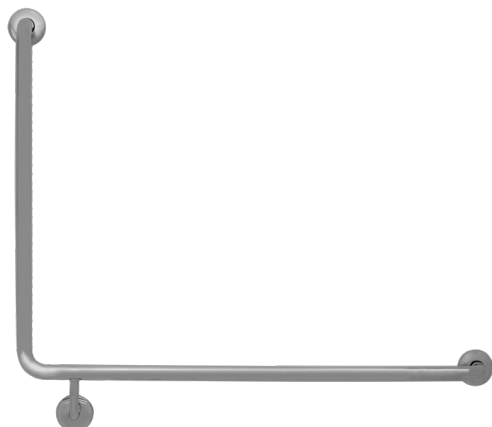

Materials & Features

Stainless steel 90° WC grab rail meets the requirements of AS1428.1-2009 (incl Amdt. 2010) when installed correctly. The snap flanges conceal the fixings.

Technical Detail

Rail	32mm [Dia], 304 Bright Polished Stainless Steel
Fixings	By others
SWL	1100N

Available Model
RBA4098-911

Bright Polished 90° Toilet Grab Rail, Right Hand

Related Products

RBA4008-030

Bright Polished Straight Grab rail, 300mm

RBA4098-901

Bright Polished 90° Toilet Grab Rail, Left Hand

Installation

Warning: Grab rails are no stronger than the anchors or walls to which they are attached and must be firmly secured in order to support the loads for which they are intended. Refer local codes and Installation Instructions for location of fixing points, method of attachment, etc.

Important: Installation instructions and current rough-in details should be furnished with each fixture. Do not rough in without certified dimensions. Dimensions are subject to manufacturer's tolerance of +/-10mm.

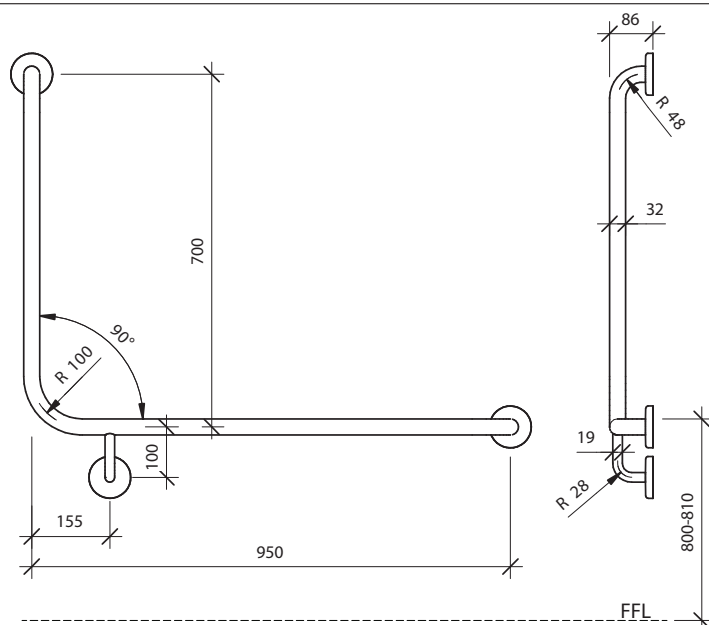

*All dimensions in mm



The illustrations and descriptions herein are applicable to production as of the date of this Technical Data Sheet. Revised 04/21 © 2021 by RBA Group TD/Model RBA4098-91/1/0421