

## MODELS

## 4.5/3L STAINLESS STEEL WC SUITE

**RBA5600-001-850**

4.5/3L Stainless Steel WC suite | Accessible + Seat | P-Trap

**RBA5600-001-851**

4.5/3L Stainless Steel WC Suite | Accessible + Seat | S-Trap



\*RBA5600-001-851 Shown



As improvements in the design and performance of RBA products are continuous, specifications may be subject to change without notice. The illustrations and descriptions herein are applicable to production as of the date of this Installation Instructions Sheet. Revised 07/23 © 2023 by RBA Group II/Model RBA5600-001-850, RBA5600-001-851/0723

## Components Supplied:

- P-Trap stainless steel pan
- S-Trap converter [incl. with RBA5600-001-851]
- Plastic seat, no lid
- Fowler Tasman Mk 2 cistern
- Cistern cover
- 2x Button kit
- S-clip

## Pre-Installation

Installation must be undertaken in accordance with the PCA [Plumbing Code of Australia], AS/NZS3500.1 and AS/NZS3500.2. Where multiple WC's may be installed, correct hydraulic water supply sizing must be undertaken to ensure that each flushing device servicing each WC is able to operate correctly under probable simultaneous demand. A minimum water supply pressure of 300kPa is required for flushing device installation along with a minimum 25mm Cu or equivalent water supply line size for single flushing device installation only.

Pan is wall faced and should preferably be fixed to a masonry wall with suitable wall anchors [provided by others].

**Note:** This product should be installed, by suitably qualified persons, in a fit for purpose application, to suitable materials, using suitable fixings and comply with any relevant codes. It should be inspected periodically for signs of wear and tear that may affect performance or safety.

Dimensions are subject to manufacturer's tolerance of +/-10mm. Rough-in should be completed with each fixture.

**Important:** Installation Instructions are subject to change without notice. Please visit **our websites** for latest revision.

## Dimensions & Rough In

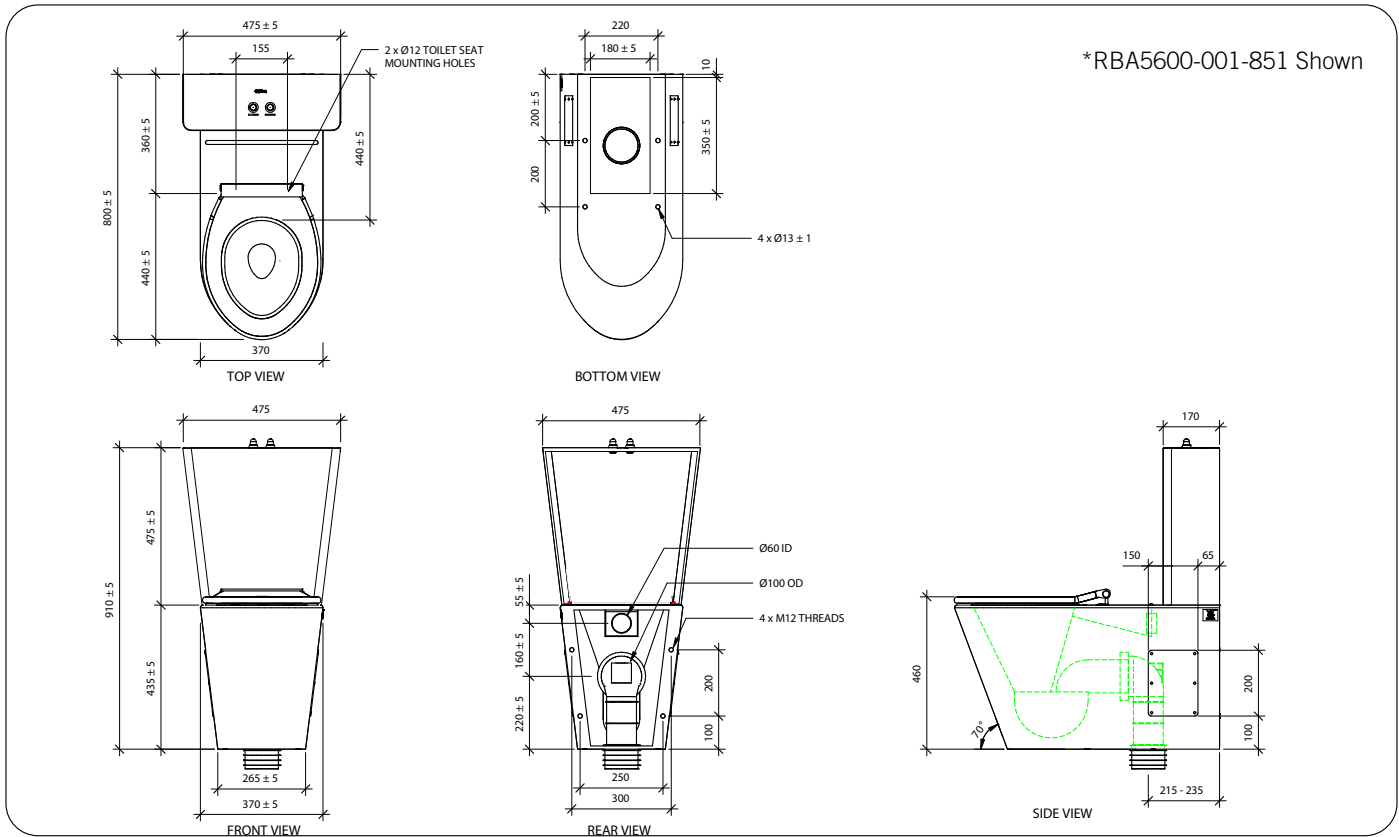
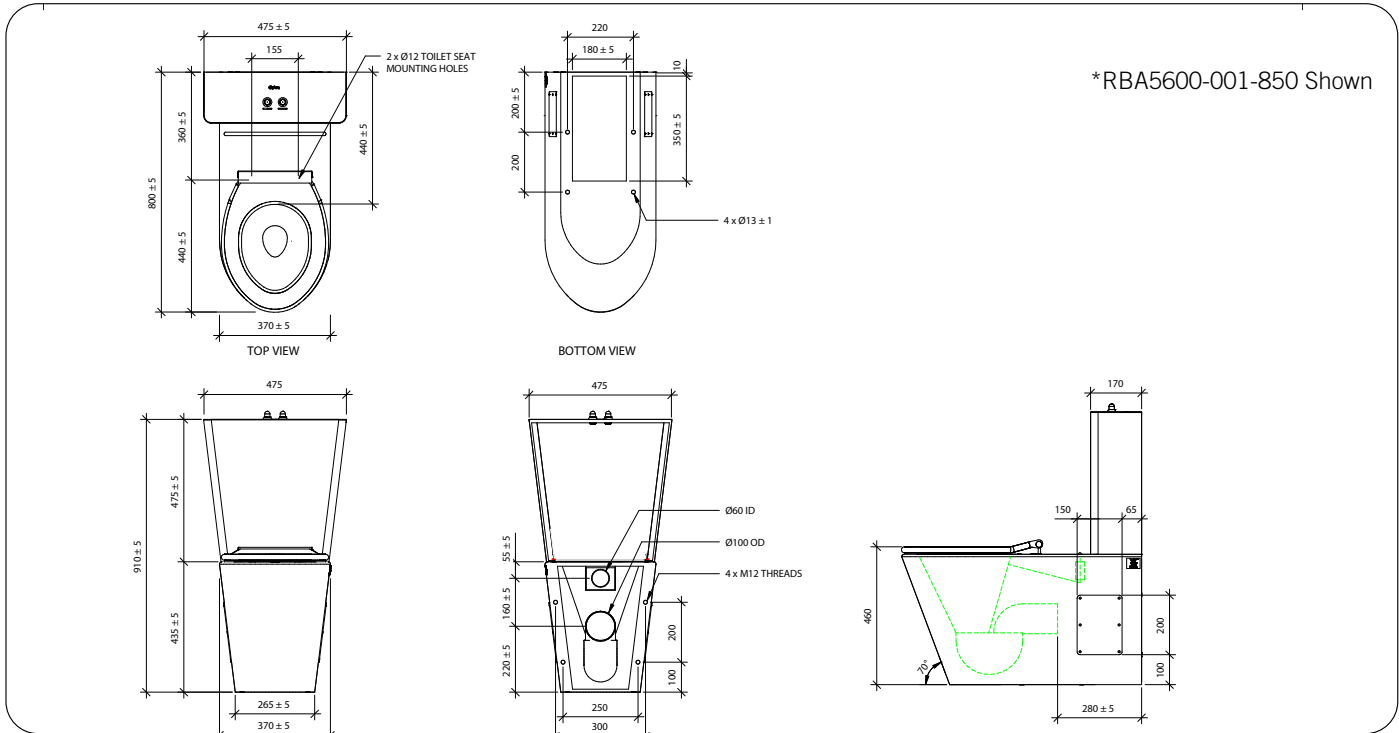

## Installation

### Pan Installation

1. Check supplied toilet against rough-ins provided in the Installation Instructions.
2. Remove access panels and place them in a safe area. When installing multiple toilets, make sure to identify which access panel matches which pan.
3. If not pre-formed, make sufficient penetrations through the wall and/or floor as determined from the drawing, to allow for the 100mm waste pipe, 50mm flush pipe and:
  - a. If rear fixed, 4 threaded nuts are located in the rear of the toilet, to allow for suitable M12 rods [supplied by others] to pass through.
  - b. If front fixed, mounting holes are located in the base of the toilet, to allow for suitable ground anchors [supplied by others] to pass through.
4. Determine floor mounting location by mocking up.
5. For P-trap installation, fit 100mm pan collar to the outlet with sufficient 100mm pipe to extend through the wall. Alternatively, the waste and flush pipes may be pre-plumbed and the pan pushed onto the pipework.
6. For S-trap installations, install S-trap converter onto waste pipe. Location of floor penetration should be determined from the drawing.

### Cistern Installation

7. Sit cistern cover in position on top of the pan, marking the top of the cover. Remove cover and fix the S-clip to the wall, such that it engages the return edge of the cover.
8. Mark out pilot holes to mount cistern, ensuring they are level. Cistern fixing points are to be 420mm above top of pan and 182.5mm from the centreline.
9. Install mounting hardware [supplied by others] into marked pilot holes, leaving screws protruding 10mm.
  - a. For installation into masonry, use suitable wall anchors.
  - b. For installation into timber, use suitable screws.
10. Cut flush pipe to suit installation, removing all burrs.
11. Install flush pipe into the toilet inlet with 60mm Kee Seal. Fit coupling nut and seal onto flush pipe.
12. Lower cistern onto the pipe and hook over the mounting screws.
13. Hand-tighten coupling nut and tighten mounting screws so that cistern is secure.
14. Flush water supply line and then connect water supply to the cistern.
15. Actuate inlet valve and check for leaks. Adjust water level to the WL2 mark with adjustment screw.
16. Ensure correct flush volumes, 4.5L full flush, 3L half flush.
17. Install button escutcheon and nut into the cistern cover.
18. While holding buttons in position in the cover, slide cover into position, ensuring the S-clip is engaged. Secure the bottom of the cover with M5 screws [supplied].
19. Unscrew plug bolts and fit seat to pre-drilled holes. Replace the access panels.