

MODELS

RBA MODULAR SHOWER RAILS

RBA4601-Series

Raffaello Shower T-Rail

RBA4604-Series

Raffaello 5 Star Shower T-Rail Kit

RBA4605-Series

Raffaello 5 Star Shower T-Rail Kit & Mixer

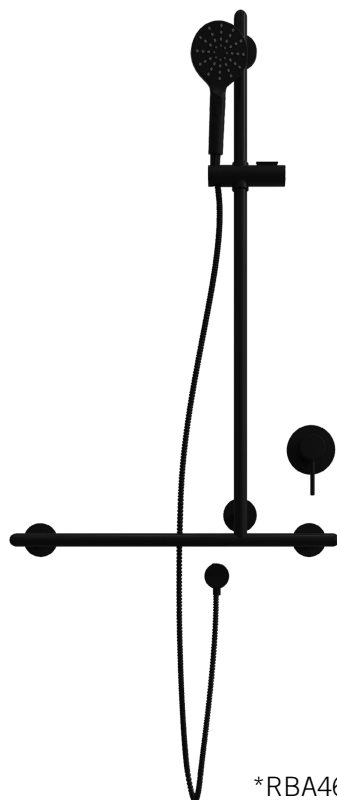

*RBA4605-068 -
Right Hand Installation Shown



Attention

For optimum installation, use at least 3 suitable screws for each wall plate. Screws should be selected to suit the wall type. Grab Rails are no stronger than the anchors or walls to which they are attached, and therefore, must be firmly secured in order to support the loads for which they are intended.

Exceeding the maximum load values may cause permanent product damage. If this happens, cease use until checked by a specialised maintenance person. Improper use, such as for gymnastic exercises or as a step, may cause accidents with serious consequences. Reliable operation and product safety depend on the way the products are installed and used. Ensure installation is performed by qualified personnel. Incorrect installation can seriously compromise product functionality.

Maintenance and Cleaning Instructions

Do not use detergents containing bleach, acids, alkalis, or chlorine or abrasive products. Do not use abrasive objects [e.g. scouring pads]. Do not use chemicals that can damage plastic. Clean the surface with water and a neutral detergent; rinse carefully and dry with a clean cloth. If alternative cleaning methods and/or chemicals are used, warranty may become void.

Tools Required

- Screw Driver
- Plumbers Tape
- Extended Driver Bit
- Spirit Level

Components Supplied For RBA4601-Series



1x Horizontal Rail



4x Flange Cover



4x Wall Plate

• 4x Flange Button



4x Bracket Post



4x Bolt



12x Screw



12x Pin



1x Rail Connector



1x Vertical Rail

Components Supplied For RBA4604-Series

Same components supplied as RBA4601-Series plus the inclusion of the below



1x Slider



1x Shower Handset

Components Supplied For RBA4605-Series

Same components supplied as RBA4601-Series plus the inclusion of the below



1x Slider



1x Shower Handset



1x Mixer

Part 1 - Install Horizontal Rail

1. Select the horizontal rail first and lay flat with thread facing up.



2. Place bracket post onto rail



3. Slide flange cover over post



4. Insert bolt through wall plate



5. Insert wall plate and bolt assembly



6. Tighten



7. Repeat for other fixing points



8. Ensure rail is level. Mark location to install.



9. Position flange cover so the hole is over the screw fixing point. Secure the first screw.

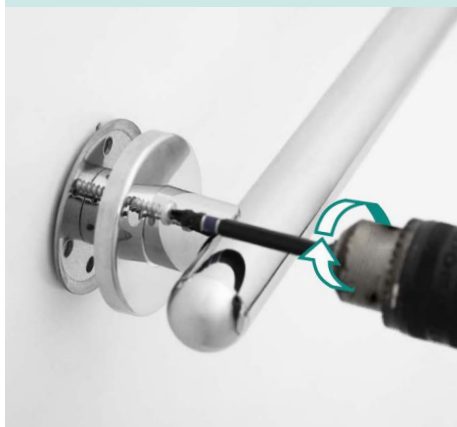

10. Rotate the flange cover so the hole is positioned over a new screw fixing point. Repeat until four screws are securing the wall plate.



11. Push flange cover over wall plate and insert flange button.

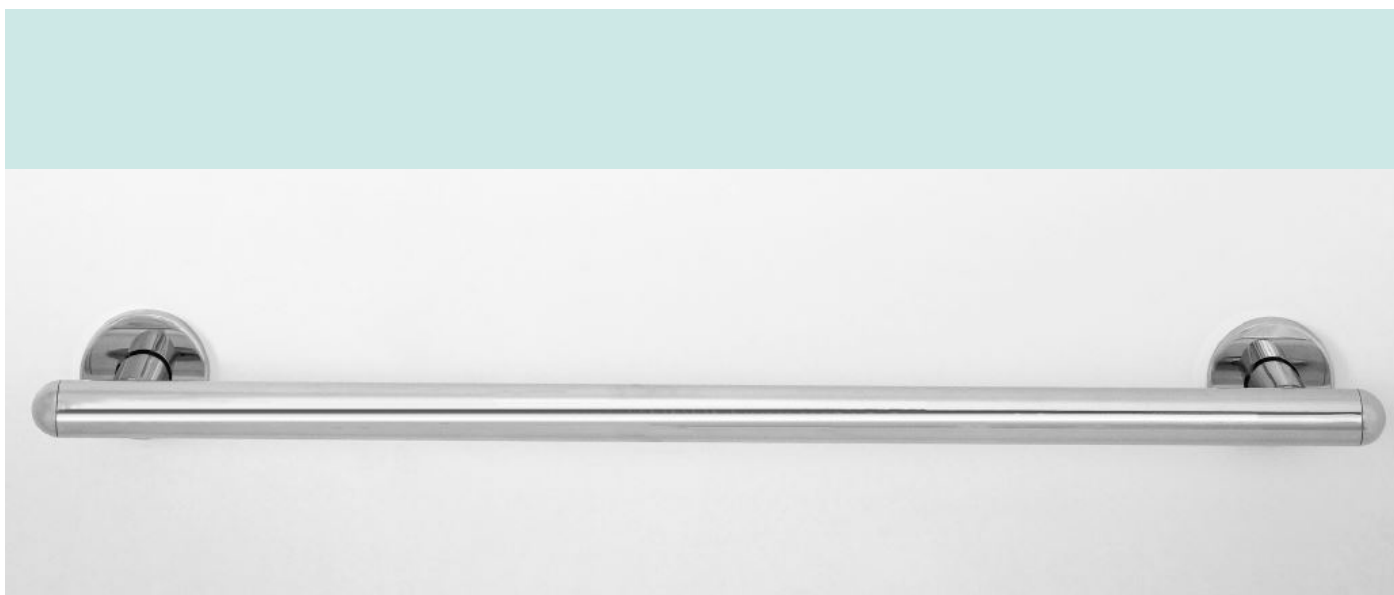

Part 2 - Install Vertical Rail

12. Remove the bottom end cap from the vertical rails and replace it with the supplied connector piece.

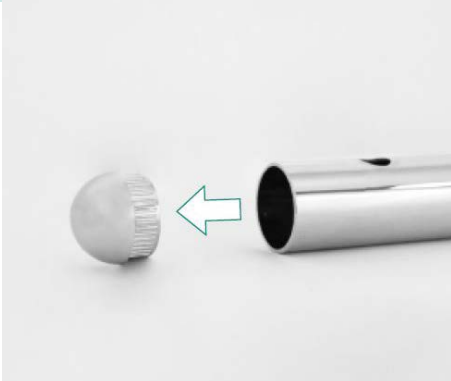

13. Position vertical rail on horizontal bar in the correct location. Ensuring the installation is level and the vertical rail is tight against the horizontal rail.

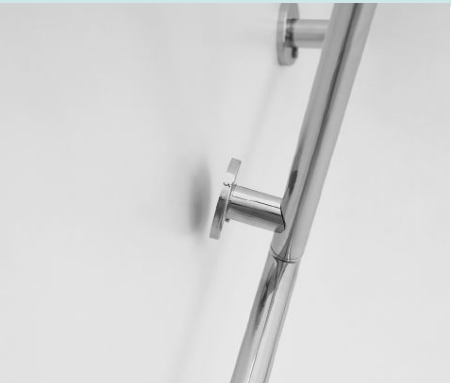

14. Fix vertical rail to wall and repeat steps 9-11.

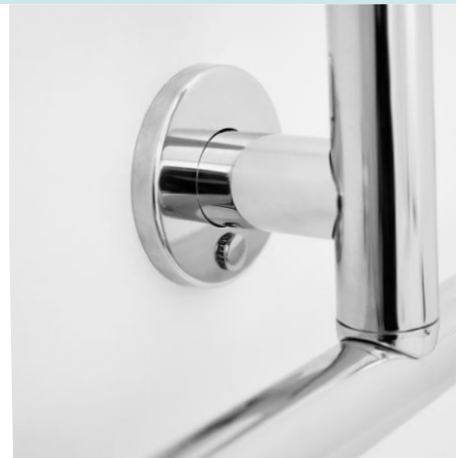

Note: This product should be installed, by suitably qualified persons, in a fit for purpose application, to suitable materials, using suitable fixings and comply with any relevant codes. It should be inspected periodically for signs of wear and tear that may affect performance or safety.

Dimensions are subject to manufacturer's tolerance of +/-10mm. Rough-in should be completed with each fixture.

Important: Installation Instructions are subject to change without notice. Please visit **our websites** for latest revision.

