

## DIMENSIONS

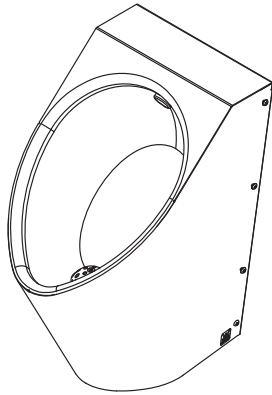

HEU URINAL

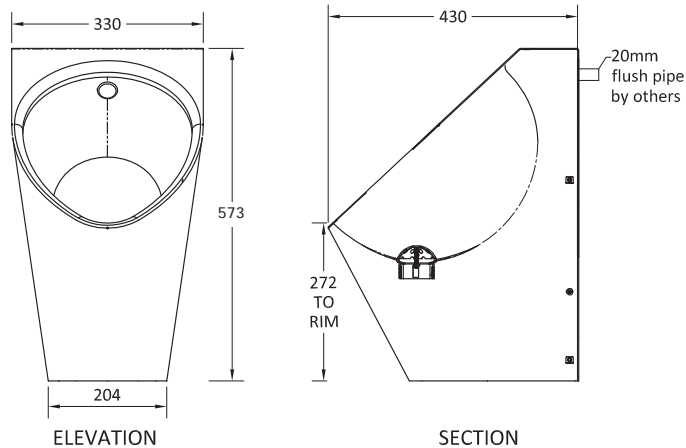

**Important:** Installation instructions and current rough-in details should be furnished with each fixture. Do not rough in without certified dimensions. Dimensions are subject to manufacturer's tolerance of +/-10mm.



For further information,  
contact the nearest RBA Group office:  
**SYDNEY • MELBOURNE • BRISBANE • PERTH • AUCKLAND**  
Australia 1300 788 778 | [www.rba.com.au](http://www.rba.com.au)  
New Zealand 0800 722 111 | [www.rbagroup.co.nz](http://www.rbagroup.co.nz)



RBA II/RBA8820-100/021+



## INSTALLATION INSTRUCTIONS

### RBA8820-100 HEU URINAL



## ROUGH-IN

The urinal should be installed so that the top is 900mm from the finished floor, or as directed by the specifier or builder.

For Junior Height levels refer to local code requirements.

Flush pipe should be 20mm OD copper tube, using long radius bends terminating 100mm from the finished wall, in the location shown. Pipe should be protected during construction to ensure correct seal is made with keyseal. Straight pipe is required to enter the keeseal, ensure bends are kept within the wall.

Waste pipe should be 50mm uPVC, terminated in the location shown, and extend 150mm from the finished wall. Outlet is set up to suit a 50mm low level plastic "P" trap (by others).

## INSTALLATION

Remove the fixing frame and access panel from the urinal, and secure the frame to the wall using appropriate fixings. Ensure that the frame is level and at the correct height.

If not already fitted, fit the keyseal into the inlet socket, and determine the length of flush pipe required.

The flush pipe should be cut to length, and the end of the pipe bevelled and cleaned to ensure correct penetration of the keyseal.

Fit the LLP trap to the urinal, cut the waste pipe to suit.

Ensure that the keeseal and flush pipe are lubricated with a suitable lubricant, and the urinal may be pushed into position over the flush pipe.

Secure the urinal to the frame with security screws provided, connect the waste pipe, and check for leaks.

## ROUGH-IN

### Mounting Plate & Rough In Locations

