

DIMENSIONS - RBA8121-100 [FRONT FIXED]

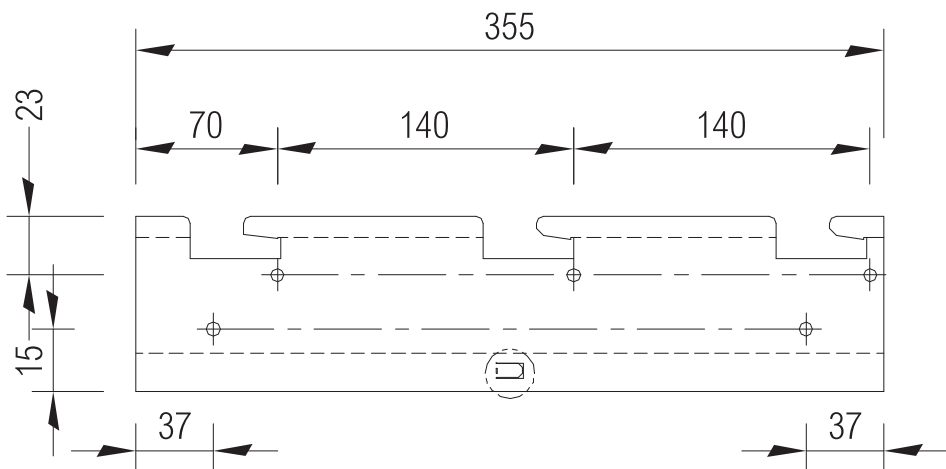

DIMENSIONS - RBA8121-144 [REAR FIXED]

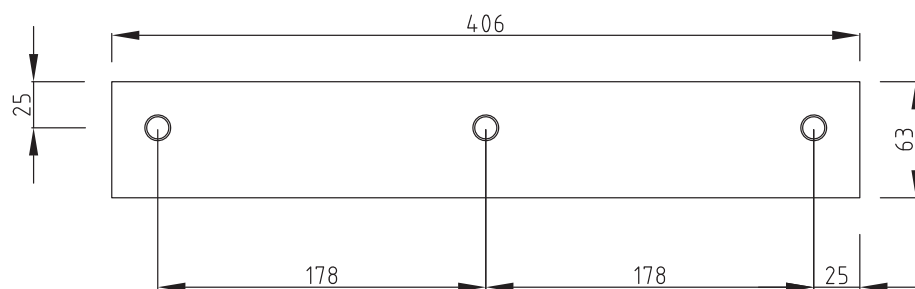

For further information,
contact the nearest RBA Group office:
SYDNEY • MELBOURNE • BRISBANE • PERTH
Phone: 1300 788 778 • Fax: 1300 788 878
info@rba.com.au • www.rba.com.au

II/Model RBA8121-100+144/0810



INSTALLATION INSTRUCTIONS

RBA8121-144 STAINLESS STEEL SECURITY SHELF [REAR FIXED]

RBA8121-100 STAINLESS STEEL SHELF [FRONT FIXED]

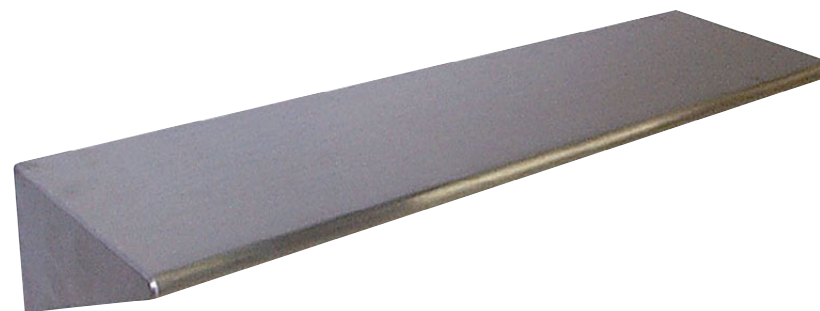

INSTALLATION - RBA8121-100 [FRONT FIXED]

- 1 Level and mount wall bracket. Use appropriate wall anchors. (Wall anchors by others)
- 2 Line up tabs with the slots on the wall bracket.
- 3 Rotate shelf flush with wall.
- 4 Ensure that shelf is flat against wall and tap into place from the left side until locking tab engages. (This may require a rubber mallet)

INSTALLATION - RBA8121-144 [REAR FIXED]

The RBA A1821-RM Stainless Steel Security Shelf is designed to be installed on finished wall from rear [typically via a plumbing duct]. Each shelf houses 3 heavy duty welded nuts with matching threaded rods for securing to wall.

INSTALLATION - RBA8121-100 [FRONT FIXED]

