

MODELS

SELF CLOSING SHOWER VALVE

RBA1055-510

Self Closing Shower Valve | Short Run

RBA1055-530

Self Closing Shower Valve | Long Run [shown]



As improvements in the design and performance of RBA products are continuous, specifications may be subject to change without notice. The illustrations and descriptions herein are applicable to production as of the date of this Installation Instructions Sheet. Revised 08/25 © 2025 by RBA Group II/Model RBA1055-series/0825

Description

Self closing valves designed for public areas, available in a bright chrome finish and cast from DZR brass. Single connection to water supply line, to either cold or mixed water.

Technical Data

Inlet/Outlet:	3/4" BSP [G3/4"] Female
Operating pressure:	200 – 500 kPa
Flow Time:	7-10 seconds [RBA1055-510] 20-40 seconds [RBA1055-530]
Maximum Temp.:	55°C

Dimensions

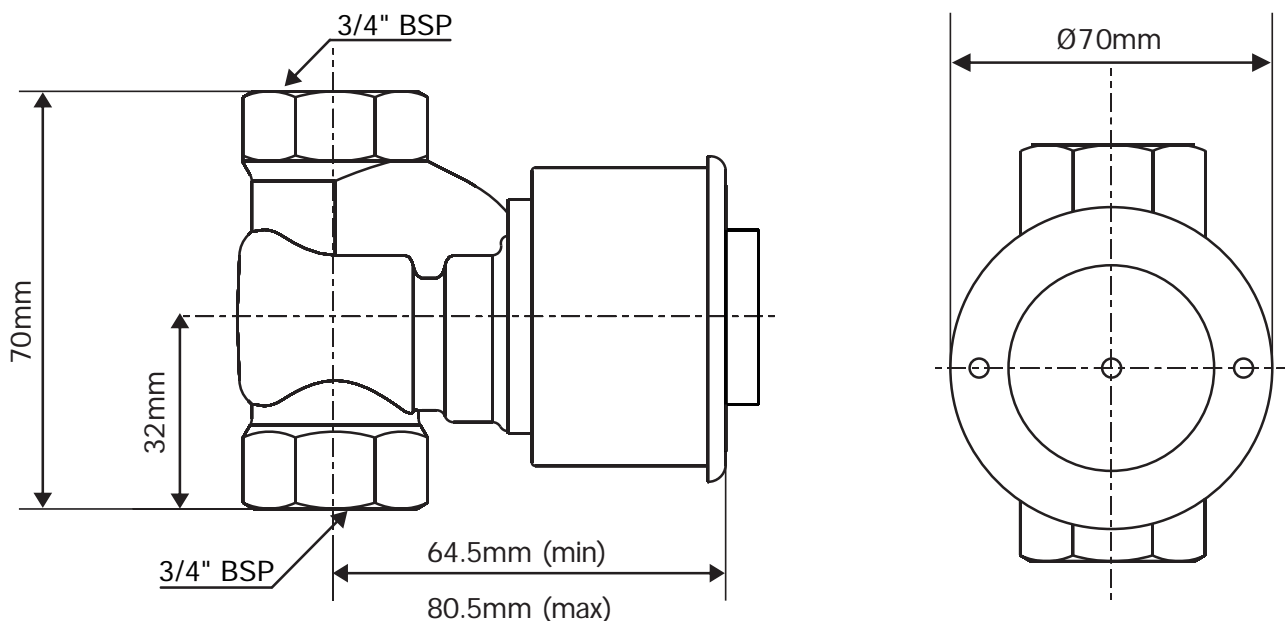

Installation Notes

- Please read the entirety of this booklet before commencing installation. Unit is to be installed in accordance with the Plumbing Code of Australia [PCA] and AS/NZS3500 plus all local and statutory requirements. Heated water installations for sanitary fixtures shall comply with the temperature requirements of the PCA and AS/NZS3500.
- All wall penetrations in wet areas are to be in accordance with NCC Vol.2: Wet Areas.
- Please leave this documentation with the owner of the fixture when finished.
- Avoid harsh cleaning chemicals. Only clean with a soft, clean microfibre cloth with mild soap and water. For more information refer to our Warranty, Cleaning & Care Guide.
- This product should be installed, by suitably qualified persons, in a fit for purpose application, to suitable materials, using suitable fixings and comply with any relevant codes. It should be inspected periodically for signs of wear and tear that may affect performance or safety.
- Dimensions are subject to manufacturer's tolerance of +/-10mm. Rough-in should be completed with each fixture.
- Installation Instructions are subject to change without notice. Please visit our websites for latest revision.

Installation Below Outlet

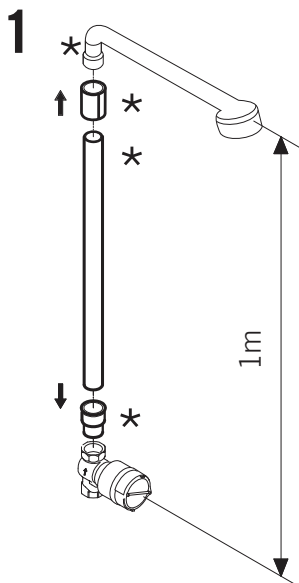

* Not supplied with product

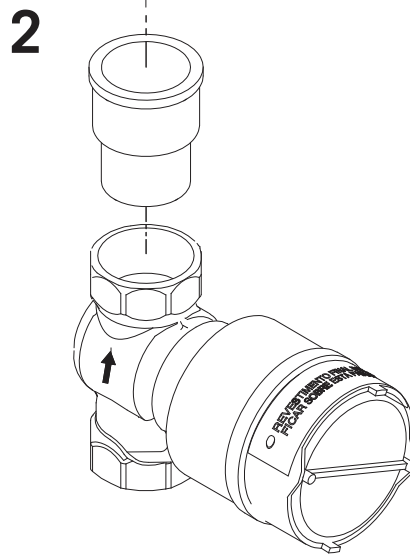

Ensure flow arrow marked on tap body aligns with intended direction of flow

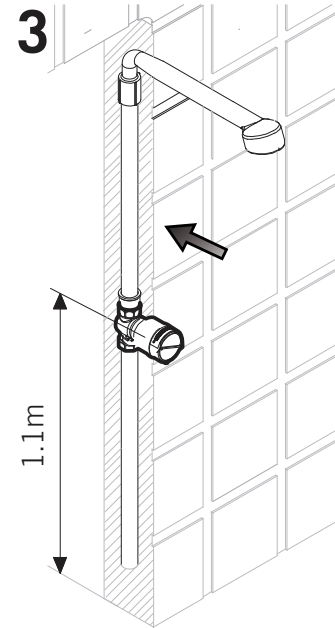

4

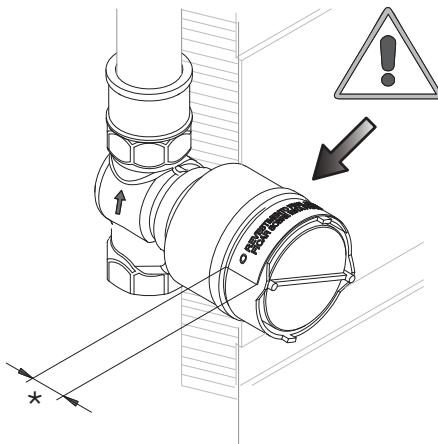

* Max depth shall not exceed depth of plastic cover

5

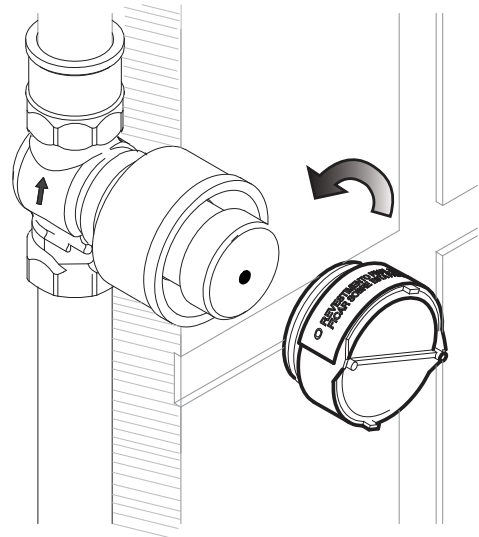

6

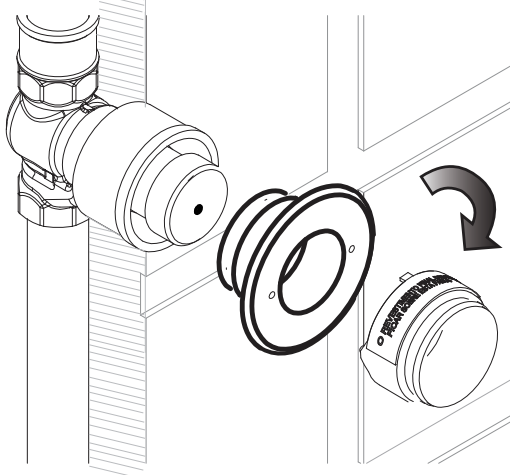

7

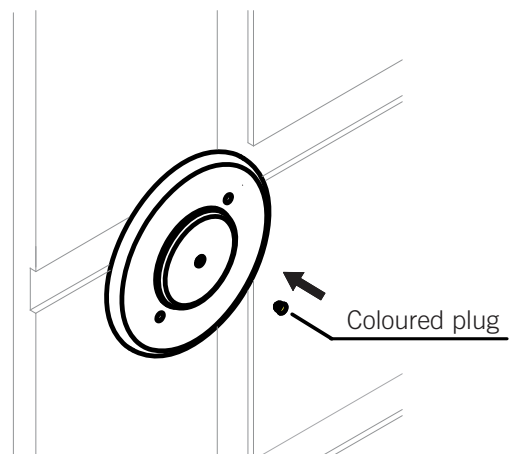

Installation Above Outlet

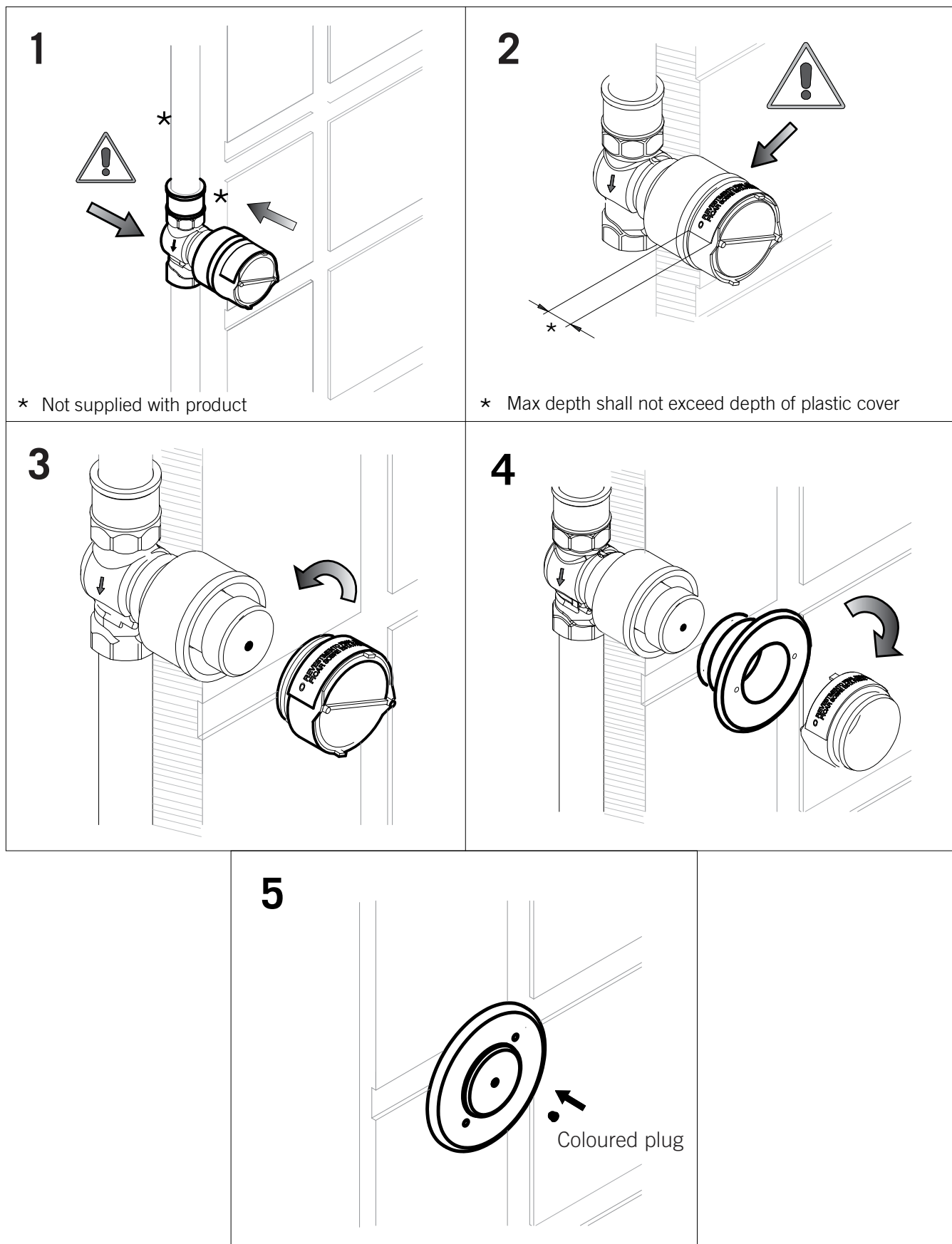

Troubleshooting

Problem	Probable Cause	Solution
No flow or low volume	Water turned off Water outlet blocked	Turn on Remove the blockage
Water flows continuously or Short/ long flow time	Cartridge blocked with dirt Cartridge damaged Valve direction incorrect	Remove and clean* Replace the cartridge*
Leak under knob	Cartridge damaged	Replace the cartridge*

*Using RBA1055-999-001 Spanner Key, sold separately.

Maintenance Keys

1. Removing the escutcheon

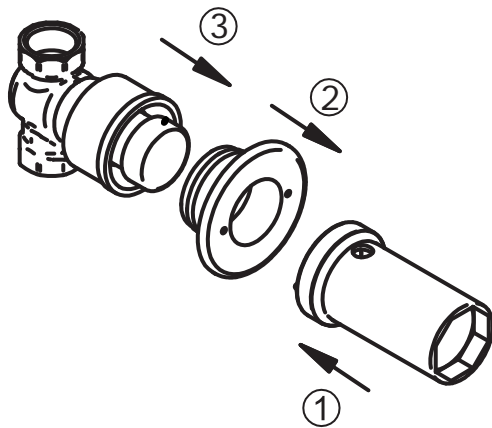

2. Removing the cartridge

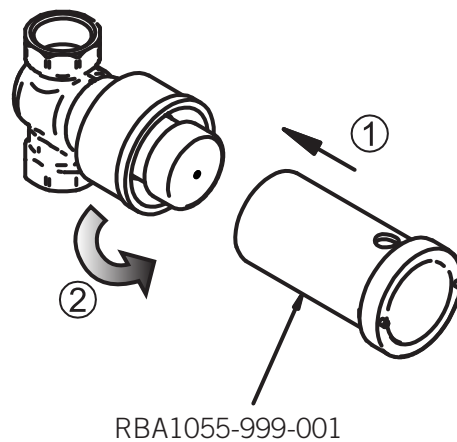

3. Servicing the cartridge

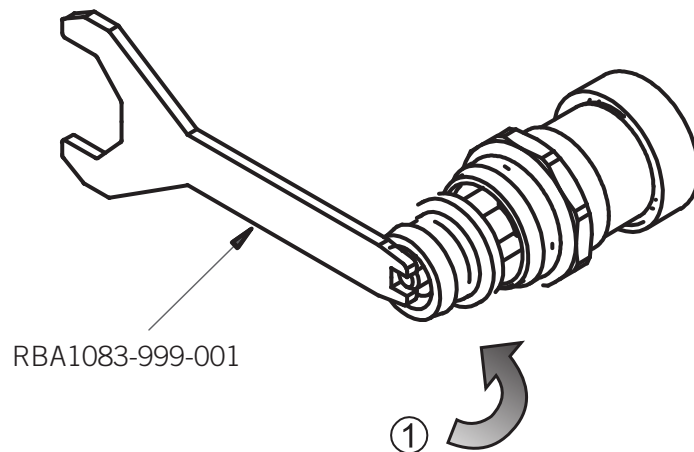

Note: This product should be installed, by suitably qualified persons, in a fit for purpose application, to suitable materials, using suitable fixings and comply with any relevant codes. It should be inspected periodically for signs of wear and tear that may affect performance or safety.

Dimensions are subject to manufacturer's tolerance of +/-10mm. Rough-in should be completed with each fixture.

Important: Installation Instructions are subject to change without notice.

Please visit www.rba.com.au for latest revision.

Spare Parts

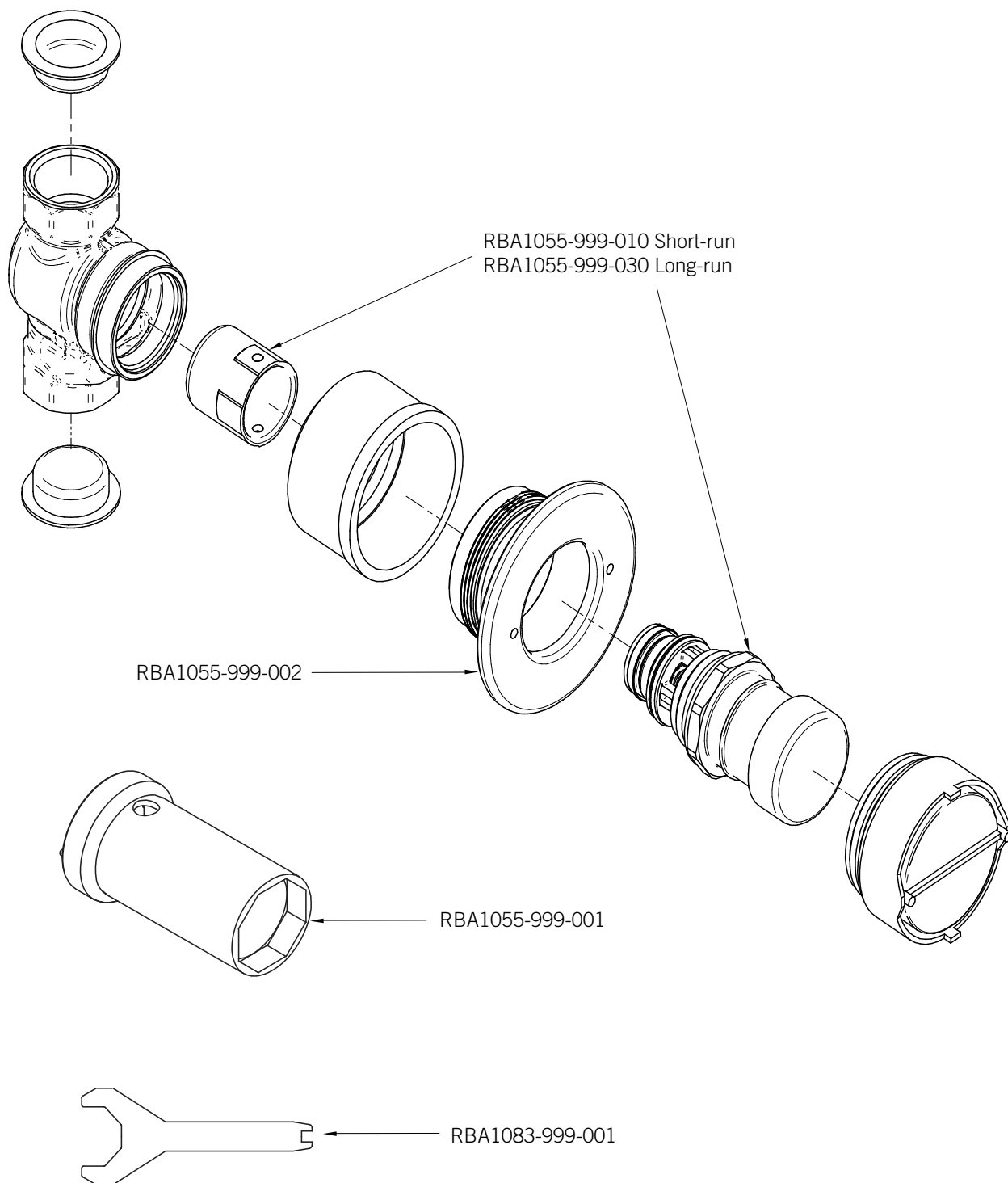

RBA Code No.	Description
RBA1055-999-030	Long-run Cartridge with Coloured Plugs [20-40 Seconds]
RBA1055-999-010	Short-run Cartridge with Coloured Plugs [7-10 Seconds]
RBA1055-999-002	Escutcheon
RBA1055-999-001	Special key
RBA1083-999-001	Spanner key